

# Heat Recovery Ventilators

## Light Commercial

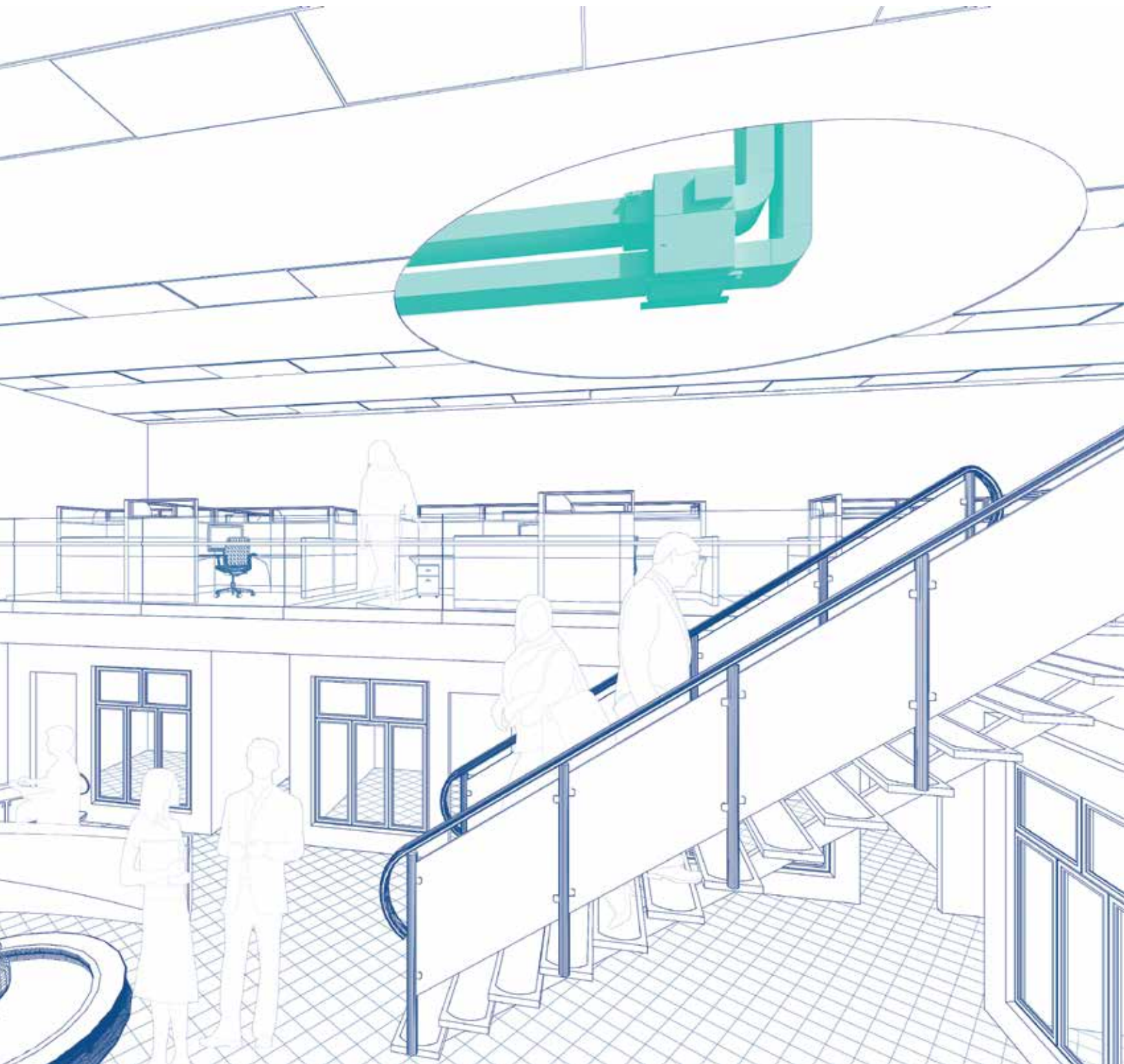

## Heat Recovery Ventilators



**SHR6904**

250 to 690 CFM\*

**SHR6905R**

250 to 690 CFM\*

**SHR11004**

480 to 1050 CFM\*

**SHR11005R**

370 to 1100 CFM\*



**SHR8004**

370 to 800 CFM\*

**SHR14104**

640 to 1410 CFM\*



**SHR8005R**

370 to 800 CFM\*

**SHR14105R**

640 to 1410 CFM\*

\*Airflow at 0.4 w.g., see technical sheets for more details.

## Key Advantages

### German Made EBM-PAPST™ Motors

Backward inclined motorized impellers and three speeds. Unequalled longevity and reliability.



### Superior Efficiency

Our motors are among the most energy efficient on the market!

### Filters

Washable Electrostatic Filters. **MERV6** High Efficiency Filters (optional).

### Electronic Control Boards

Superior microprocessor technology efficiently controls operation of unit while making it easy to connect to existing HVAC equipment, Building management system and convenient wall controls (see below).



### Ease of Maintenance

The motors are mounted on a removable sliding base for quick and easy serviceability.

### Reversible Door Panels

The reversible door panels are standard on these units. Access doors can be reversed to fit installation requirements.

### Aluminum Fixed-Plate, Cross-Flow Heat Exchanger

Capable of transferring heat between airstreams. Cores are manufactured in our facility to assure the highest level of quality.



## Controls



ECO-Touch



EDF7



EDF1/EDF1R

## Dehumidistats



MDEH1

## Timers



RTS3



RTS2

### Customer Support:

Canada 800.565.3548 • CANADASupport@fantech.net • [www.fantech.net](http://www.fantech.net)

Fantech reserves the right to modify, at any time and without notice, any or all of its products' features, designs, components and specifications to maintain their technological leadership position.