

Product Instructions

viega

3 Speed Circulator Pumps

Applications

Viega offers two 3-speed, wet rotor, direct drive in-line circulator pumps designed for residential and light commercial applications. These circulators are quiet and maintenance free, making them ideal to use in primary and / or secondary loop piping.

Features

- Choice of two 3-speed circulators; low and high head
- Ease of wiring; plug-in quick connect terminals
- Use as primary loop and / or secondary loop circulator
- Ideal circulator replacement for Viega's Stations
- Maintenance free

Specifications

Low Head

Flow range:	0 - 17.5 US GPM
Head range:	0 - 19 feet
Motor:	2 pole, single phase
Maximum fluid temperature:	230°F
Minimum fluid temperature:	36°F
Maximum working pressure:	145 PSI
Maximum glycol mix:	50%

High Head

Flow range:	0 - 34 US GPM
Head range:	0 - 30 feet
Motor:	2 pole, single phase
Maximum fluid temperature:	230°F
Minimum fluid temperature:	36°F
Maximum working pressure:	145 PSI
Maximum glycol mix:	50%

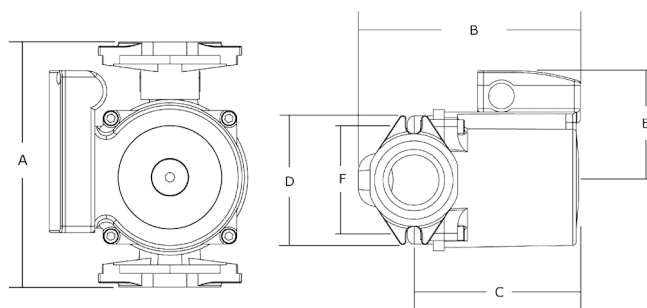
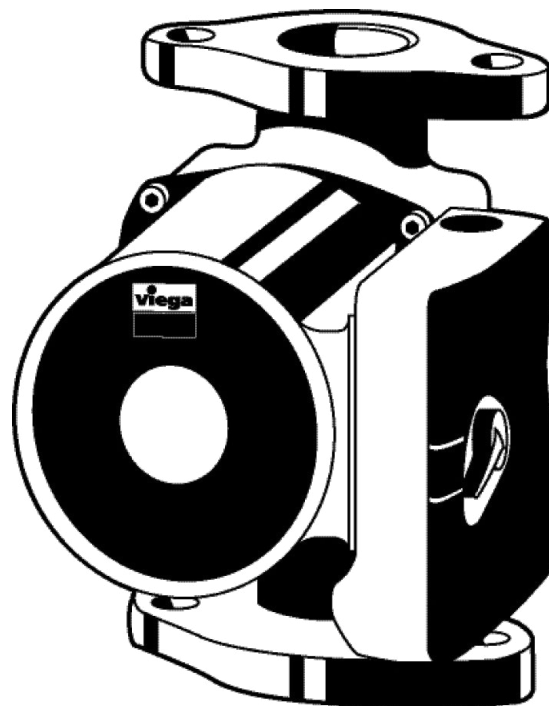

Stock Code	A	B	C	D	E	F
12126	6-1/2"	5-1/4"	4"	4-3/16"	3"	3-5/32"
12127	6-1/2"	6"	4-7/8"	3-7/8"	3-7/16"	3-5/32"

Viega... The global leader in plumbing, heating and pipe joining systems

301 N. Main, 9th Floor • Wichita, KS 67202 • Ph: 800-976-9819 • Fax: 316-425-7618 • www.viega.com

©2012, ProPress®, FostaPEX®, GeoFusion®, Seapress® MegaPress®, MegaPressG®, and Viega® are registered trademarks of Viega GmbH & Co. PureFlow®, Smart Connect®, Climate Panel®, Climate Mat®, Climate Trak®, MANABLOC®, Radiant Wizard®, S-no-Ice®, Snap Panel®, XL® and XL-C® are registered trademarks of Viega LLC. MiniBloc™, Rapid Grid™, ProRadiant™, PolyAlloy™, SmartLoop™ and Zero Lead™ are trademarks of Viega LLC; ProPressG™ and ViegaPEX™ are trademarks of Viega GmbH & Co. KG. RIDGID® is a registered trademark of RIDGID, Inc.

Product Instructions

viega

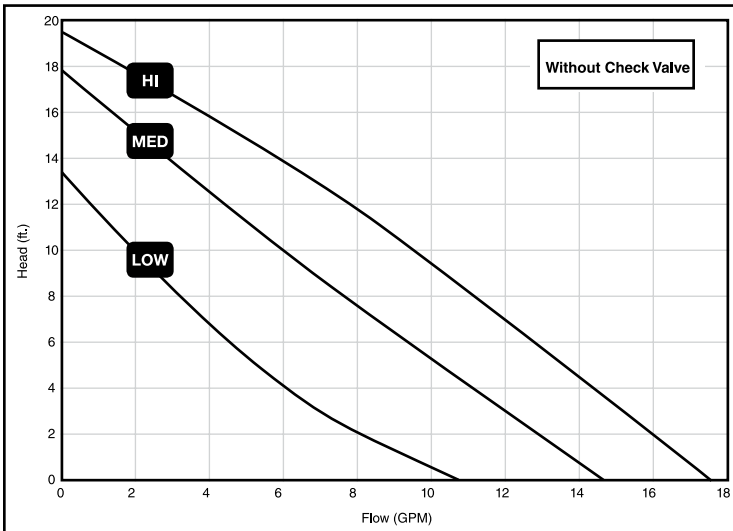

Stock Code	Speed	Amps	Watts	HP
12126	HI	0.75	87	1/25
	MED	0.66	80	1/25
	LOW	0.55	60	1/25

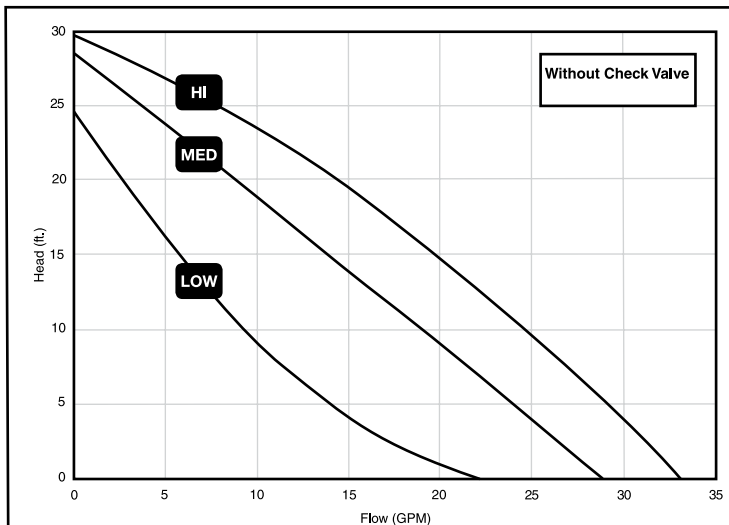

Stock Code	Speed	Amps	Watts	HP
12127	HI	1.8	197	1/6
	MED	1.5	179	1/6
	LOW	1.3	150	1/6

Installation Tips

- Ensure system is free from debris that could damage circulator pump
- Install circulator pump above lowest point of system to avoid where the sediment would naturally collect
- Fill and purge system prior to starting the circulator pump
- Do not get the inside of terminal box wet

Wiring

- Hot lead (typically black wire) to "L" terminal
- Neutral wire (typically white wire) to "N" terminal
- Ground wire (typically green or uninsulated wire) to ground terminal

Diagram

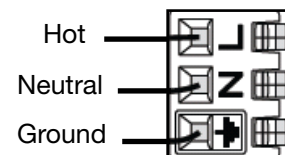

Viega... The global leader in plumbing, heating and pipe joining systems

301 N. Main, 9th Floor • Wichita, KS 67202 • Ph: 800-976-9819 • Fax: 316-425-7618 • www.viega.com

©2012, ProPress®, FostaPEX®, GeoFusion®, Seapress® MegaPress®, MegaPressG®, and Viega® are registered trademarks of Viega GmbH & Co. PureFlow®, Smart Connect®, Climate Panel®, Climate Mat®, Climate Trak®, MANABLOC®, Radiant Wizard®, S-no-Ice®, Snap Panel®, XL® and XL-C® are registered trademarks of Viega LLC. MiniBloc®, Rapid Grid™, ProRadiant™, PolyAlloy™, SmartLoop™ and Zero Lead™ are trademarks of Viega LLC; ProPressG™ and ViegaPEX™ are trademarks of Viega GmbH & Co. KG. RIDGID® is a registered trademark of RIDGID, Inc.