

SPECIFICATION SUBMITTAL SHEET



FEATURES

Sizes: 1/2" 3/4"

Maximum working water pressure 200 PSI
 Maximum working water temperature 250°F
 Capacity 13 CFM
 End connection Threaded ANSI B1.20.1

ACCESSORIES

- T & P Valve (Model TP1100A-4C, TP220-5C)
- Thermal Expansion Tank (Model WXTP)

DIMENSIONS & WEIGHTS (do not include pkg.)

SIZE		DIMENSIONS (approximate)				SHIPPING WEIGHT	
		A		B			
in.	mm	in.	mm	in.	mm	lbs.	kg
1/2	15	2 1/2	64	1 1/4	32	1	0.50
3/4	20	2 1/2	64	1 1/4	32	1	0.50

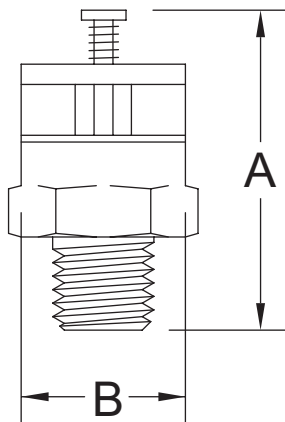

APPLICATION

Designed for installation on commercial and residential water lines to protect water supply systems and pressure vessels against internal vacuum conditions that could drain a system by siphonage, burn out heaters or collapse storage tanks.

STANDARDS COMPLIANCE

- CSA Compliance to ANSI Z21.22/CSA 4.4

MATERIALS

Valve body Brass, ASTM B 16
 Elastomers Buna Nitrile, FDA 21, 177.2600
 Silicone, FDA 21, 177.2600
 Internals Stainless steel, 300 series
 Brass, ASTM B 16

TYPICAL INSTALLATION

