

Diverting Valve

Three-Way Diverting Valves can be used for temperature control in many heating and snowmelting applications.

Features

- Includes solder tailpieces (1-1/4" and 1-1/2" models use same valve body with different tailpieces)
 - Pre-installed high limit kit
 - Compatible with most Viega actuators
- Three Position - 18003
 Proportional Acuator - 0-10v 18025
 Non-electric Models - 16101, 16102, 16104, 16105, 16115

Specifications

Materials:
 Bronze valve body
 Brass and corrosion-resistant steel internal components

EPDM rubber seals

Actuator threads: M30 x 1.0

Max working temp.: 242°F (120°C)

Max working pressure: 145 psi 10 bar)

Max differential pressure (tight shut-off on both end positions of valve discs):

3/4"	10.9 psi (75 kPa)
1"	7.3 psi (50 kPa)
1-1/4"	2.9 psi (20 kPa)
1-1/2"	2.9 psi (20 kPa)

Dimensions

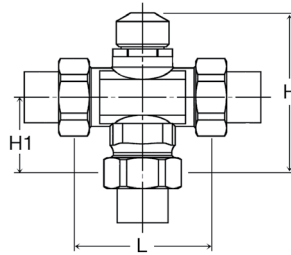

Stock Code	Size	L (in)	H (in)	H1 (in)
20001	3/4"	3.15	3.94	1.85
20002	1"	3.54	4.06	1.97
20003	1-1/4"	4.53	4.65	2.52
20041	1-1/2"	4.53	4.65	2.52

Soldered Tailpiece

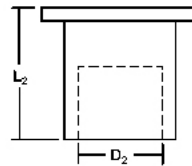

Size	D2 (in)	L2 (in)
3/4"	0.875	0.91
1"	1.125	1.18
1-1/4"	1.375	1.57
1-1/2"	1.625	1.26

ProPress Tailpiece

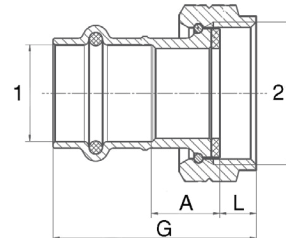

Stock Code	Size		A (in)	L (in)	G (in)
	1	2			
77764	1" x 1-1/4" BSP		0.72	0.41	2.04

Pressure Drop

Pressure drop values for Viega diverting valves may be determined from the chart at right below. 1-1/4" and 1-1/2" models share the same valve body, so the pressure drop for these models is the same.

Stock Code	Size	Type	L (in)	H (in)	H1 (in)	Weight (lbs)	Cv Rating	Flow (gpm)	Heat Capacity (BTU/H)	Pressure Drop (psi)	Pressure Drop (ft of head)
2001	3/4"	Solder	3.15	3.94	1.85	2.2	5.3	5	50,000	0.9	2.04
								6	60,000	1.3	2.94
2002	1"	Solder	3.54	4.06	1.97	3	7.6	7	70,000	0.8	1.95
								9	90,000	1.4	3.22
2003	1-1/4"	Solder	4.53	4.65	2.52	6.1	11.1	10	100,000	0.8	1.86
								12	120,000	1.4	2.68
2004	1-1/2"	Solder	4.53	4.65	2.52	6.1	11.1	13	130,000	1.4	3.15
								14	140,000	1.6	3.65

Note: Heat capacity is based on water at a ΔT of 20°F. The fluid used to calculate pressure drop across the valve is water @ 100°F

Viega... The global leader in plumbing, heating and pipe joining systems

301 N. Main, 9th Floor • Wichita, KS 67202 • Ph: 800-976-9819 • Fax: 316-425-7618 • www.viega.com

©2011, ProPress®, FostaPEX®, Seapress®, MegaPress®, MegaPressG® and Viega® are registered trademarks of Viega GmbH & Co. PureFlow®, Smart Connect®, Climate Panel®, Climate Mat®, Climate Trak®, MANABLOC®, Radiant Wizard®, S-no-Ice®, Snap Panel®, XL® and XL-C® are registered trademarks of Viega LLC. MiniBloc™, ProRadiant™, PolyAlloy™, SmartLoop™ and Zero Lead™ are trademarks of Viega LLC; GeoFusion™, ProPressG™ and ViegaPEX™ are trademarks of Viega GmbH & Co. KG.