

# Product Instructions

## Washing Machine & Ice Maker Boxes

### Installation

1. Position box between studs at desired height.
2. Secure box to a backing board with screws, or to the front of stud(s) using the nailing ear(s). In either case the front edge of the box should be flush with wall material.
3. Cut or punch opening in bottom of box if necessary for 2" plastic drain pipe and solvent cement pipe to connection on bottom of box (washing machine boxes only).
4. Connect ViegaPEX, ViegaPEX Ultra or FostaPEX tubing to PureFlow barb(s) on valve(s) as described on reverse of this sheet.
5. Install face plate by pushing plate into box until plate is flush against wall material.

### Dimensions

#### Washing Machine Box

(box dimensions without face plate or valves)

Height: 6-5/8"  
Width: 7-3/4"  
Depth: 3"

Face plate:  
8-1/4" high x 10-3/8" wide

#### Ice Maker Box

(box dimensions without face plate or valves)

Height: 5-1/4"  
Width: 5-1/4"  
Depth: 2-1/2"

Face plate:  
6-3/4" high x 6-3/4" wide

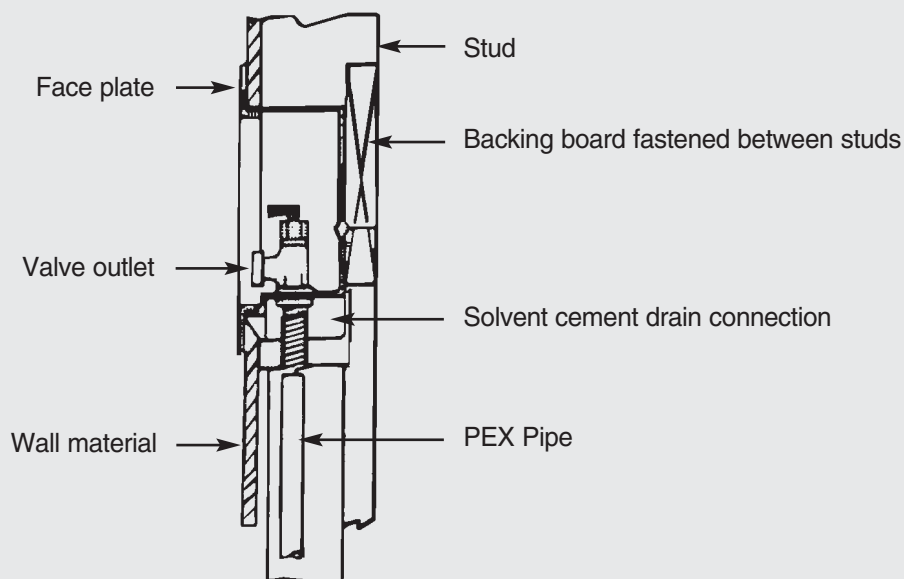
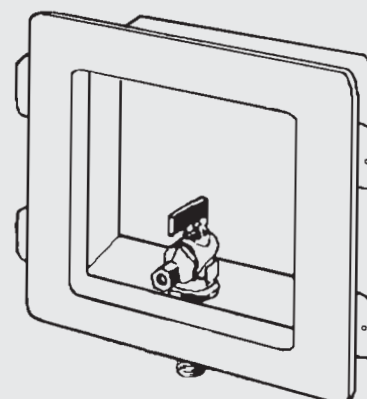
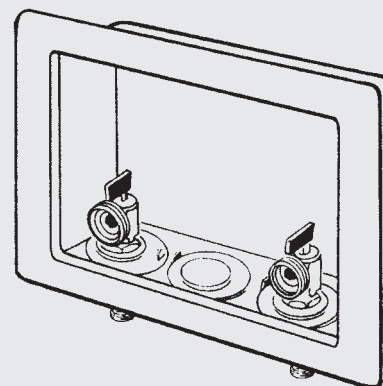

**VIEGA** • One Company... One Partner... Delivering System Solutions.

301 N. Main, Floor 9 • Wichita, KS 67202 • Ph: 877-Viega-NA • Fax: 316-425-7618 • E-Mail: service@viega.com • www.viega-na.com

# Product Instructions

## Washing Machine & Ice Maker Boxes

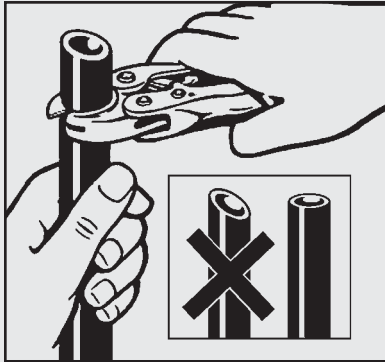

1. Square off tubing to proper length. If using ViegaPEX, continue to step 3.

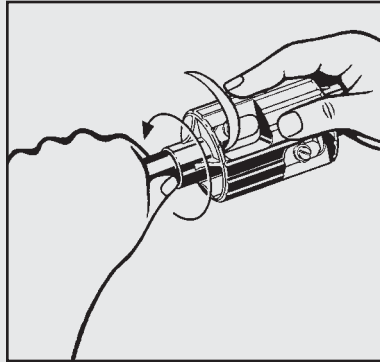

2. Insert FostaPEX tubing into prep tool, push and turn until no more resistance is felt.

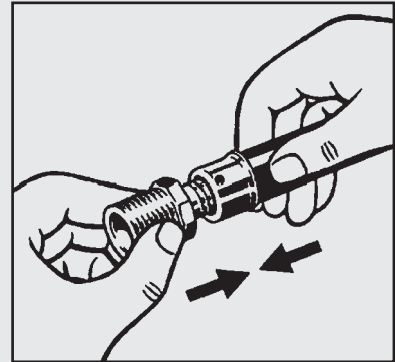

3. Slide press sleeve fully over end of tubing.

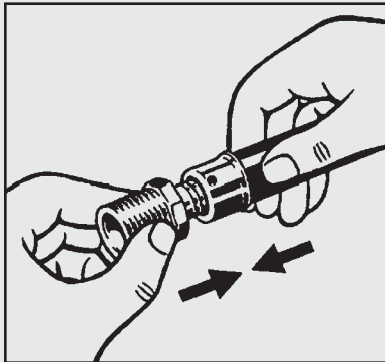

4. Insert press fitting into tubing and engage fully.

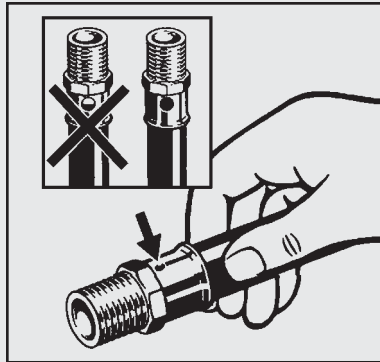

5. Check full tubing insertion at view hole of sleeve.

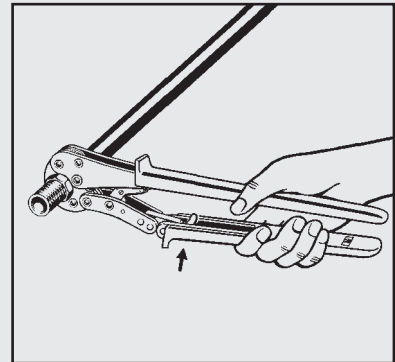

6. Position press tool perpendicular over press sleeve and close tool jaws to engage ratchet.

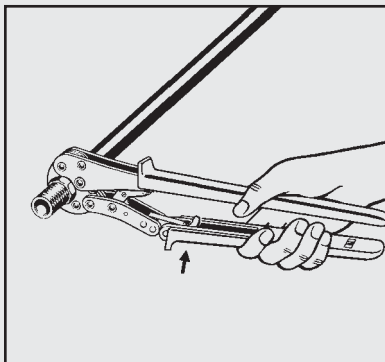

7. Close handles, utilizing trigger to reduce grip span if desired.

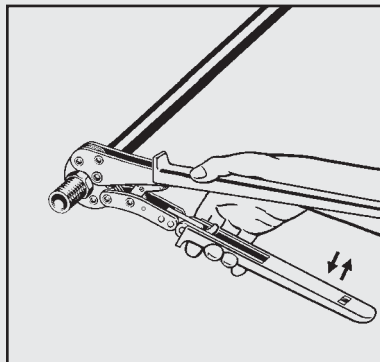

8. Extend handle and continue ratcheting until automatic tool release occurs at proper compression force.

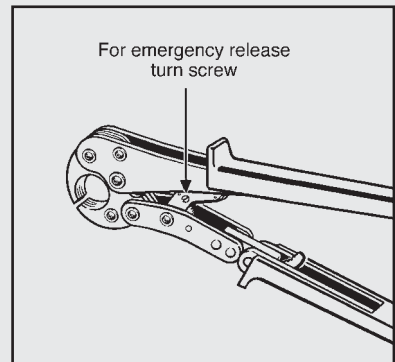

9. **WARNING:** The connection is not leakproof when the tool has been opened by emergency release.

**VIEGA • One Company... One Partner... Delivering System Solutions.**

301 N. Main, Floor 9 • Wichita, KS 67202 • Ph: 877-Viega-NA • Fax: 316-425-7618 • E-Mail: [service@viega.com](mailto:service@viega.com) • [www.viega-na.com](http://www.viega-na.com)