



FILE NO.

NOTICE

- CORRECTION PRODUCTION CHANGE
- SERVICE FLASH ADD INFORMATION

PLEASE ADD THIS NOTICE TO THE MANUALS LISTED BELOW.

CATEGORY : AIR CONDITIONER	DATE : Feb.2010
MODEL : CMH1972A	REF.No. : PL 706822
DESTINATION : U.S.A	ISSUE No. : 1

THE REASON OF CHANGE.

- A: Misprint
D: Design Change
- B: Quality Reliability
E: Addition of Missing Parts
- C: Standardization
F: Parts Compatibility

Page & Section	Key No.		Part No.	Description	Q'ty	Reference Part No.	Interchange-ability	Re-remarks
Page 3	29	Old	923 194 7399	Propeller Fan	1	852-2-2502-20200	———	A
	29	New	623 304 3500	Propeller Fan Ass'y	1	852-0-2502-18900	———	
Page 3	39	Old	923 192 4130	Thermistor Ass'y	1	8FA-0-5155-00600	———	D
	39	New	623 310 6328	Thermistor Ass'y CS-7L-2515	1	8FA-0-5155-00700	———	
		Old	-	-	-	-	———	
		New	-	-	-	-	———	
		Old	-	-	-	-	———	
		New	-	-	-	-	———	

(2) Parts changed.

Parts List



File No.

Air Conditioner

OUTDOOR UNIT
CMH1972A

Model No.	Prod.Code	Volt-Phase-Hertz
CMH1972A	1 852 356 13	230-208-1-60

CMH1972A
OUTDOOR UNIT

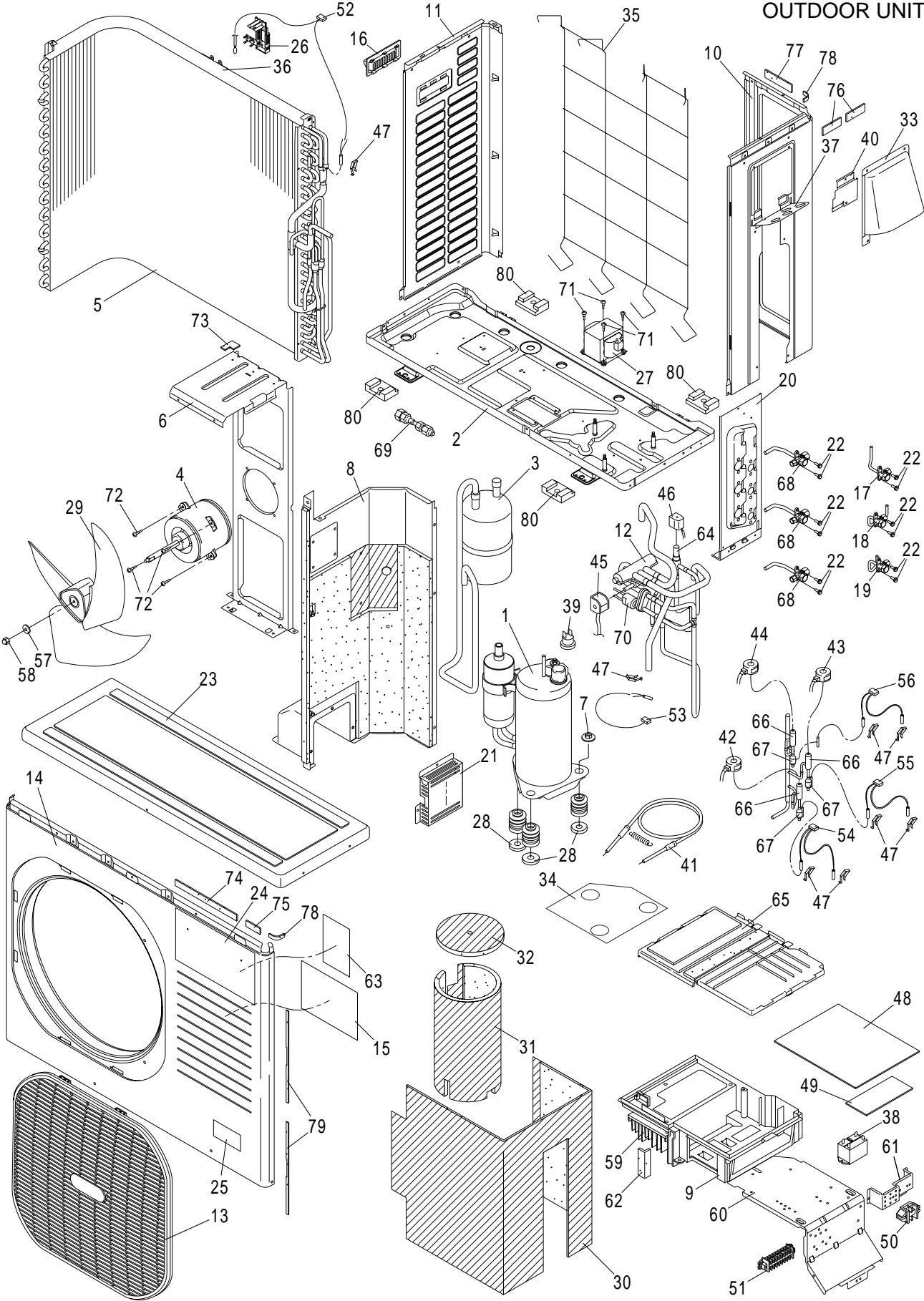

ATTENTION !

To ensure correct parts supply, please let us know followings,
when you make service parts order:

1.Part No. 2.Description 3.Q'ty 4.Volts-Hz-Ph 5.Product Model No.

CMH1972A
OUTDOOR UNIT

Key No.	Part No.	Description	Q'ty	Reference No.
* 1	923 192 4017	Comp Sub Ass'y 5KD240XAB21	1	852-0-4526-34100
2	623 313 6516	Bottom Plate Ass'y	1	852-0-2202-79402
3	923 192 4000	Accumulator Ass'y	1	852-0-4511-31400
* 4	923 191 5428	Fan Motor SIC-71FW-D490-1	1	1FA-4-M4A0-10400
5	923 192 3997	Heat Exch Cond Ass'y	1	852-0-4119-19100
6	923 191 5404	Mounting Plate, Fan Motor	1	852-2-2354-31400
7	923 193 8069	Nut Special	3	852-2-2226-15501
8	623 313 6226	Partition Plate Ass'y	1	852-0-2209-40900
9	623 191 7230	Elec.Component Box	1	852-2-5307-70601
10	623 313 6264	Side Panel	1	852-2-1114-42301
11	623 313 6257	Side Panel	1	852-2-1114-41302
* 12	623 191 7445	Solenoid Valve Ass'y STF-02U2G	1	852-0-4509-22800
13	623 191 7858	Guard	1	852-2-1321-24211
14	623 313 6240	Front Panel	1	852-2-1118-24702
15	623 193 2080	Elec. Wiring Diagram	1	8FA-2-5257-59100
16	623 191 7186	Handle	1	852-2-2303-17811
17	923 192 4093	Valve Ass'y 1/4"	1	852-0-4515-44000
18	923 192 4086	Valve Ass'y 1/4"	1	852-0-4515-44100
19	923 192 4079	Valve Ass'y 1/4"	1	852-0-4515-44200
20	623 313 6288	Support Valve	1	852-2-2222-38701
21	623 191 7421	Cover Plate	1	852-2-5315-49101
22	923 090 6908	Deltite Screw SWCH18A	12	3-9201-61601
23	623 313 6271	Top Plate Ass'y	1	852-0-1103-23220
24	923 192 4048	Mark	1	852-2-1316-44002
25	923 161 1498	Label	1	854-2-1358-95900
26	923 171 9279	Mounting Thermostat	1	852-2-5303-24501
* 27	923 191 7903	Reactor R9020A-TE-COV	1	1FA-4-L5C0-13500
28	923 191 5619	Cushion Rubber	3	852-2-2390-30800
* 29	623 304 3500	Propeller Fan Ass'y	1	852-0-2502-18900
30	923 192 4116	Insulation	1	852-2-2476-69300
31	923 192 4109	Insulation	1	852-2-2476-71900
32	923 191 5633	Insulation	1	852-2-2476-72000
33	623 313 6318	Cover Ass'y	1	852-0-2309-25120
34	923 191 5527	Sheet	1	852-2-5328-50000
35	923 191 5558	Guard Ass'y	1	852-0-1111-23801
36	923 191 5541	Mounting Plate	1	852-2-2385-15801
37	623 313 6301	Conduit Plate	1	852-2-1319-45121
* 38	923 172 7731	Power Relay EL200/240A1-F(M)	1	1FA-4-S2A0-10000
* 39	623 310 6328	Thermistor Ass'y CS-7L-2515	1	8FA-0-5155-00700
40	623 313 6295	Mounting Plate	1	852-2-2385-17802
* 41	923 193 2111	Heater K SP4407Q-09	1	8FA-0-5255-03400
* 42	923 192 4185	Magnetic Coil UKV-A014 5P A-MV	1	8FA-0-5251-15200
* 43	923 192 4178	Magnetic Coil UKV-A006 5P B-MV	1	8FA-0-5251-15300
* 44	923 192 4161	Magnetic Coil UKV-A007 5P C-MV	1	8FA-0-5251-15400
* 45	623 191 8046	Magnetic Coil STF-01AQ503UA1	1	8FA-0-5251-14600
* 46	623 193 2103	Magnetic Coil VPV-MO AQ533UB1	1	8FA-0-5251-14700
47	923 148 5877	Mounting Thermostat	8	852-2-5303-22401
* 48	623 313 6523	Circuit Board Ass'y CB-CMH1972A	1	8FA-0-5181-69800
* 49	923 192 4260	P.C.B. Ass'y POW-CMV4S1	1	8FA-0-5178-57900
* 50	923 160 7446	Terminal Base JTU30-2U	1	1FA-4-J3A0-13300

NOTE: Metal and plastic parts will be supplied basically
with necessary heat insulation pads or packing.
Each key number with an asterisk (*) means the
recommended service parts.

ATTENTION !

To ensure correct parts supply, please let us know followings,
when you make service parts order:

1.Part No. 2.Description 3.Q'ty 4.Volts-Hz-Ph 5.Product Model No.

CMH1972A
OUTDOOR UNIT

Key No.	Part No.	Description	Q'ty	Reference No.
* 51	923 193 1909	Terminal Base KTU15N-9J	1	1FA-4-J3A0-26500
* 52	923 192 4246	Thermistor Ass'y K TKS292B/295B	1	8FA-0-5259-16700
* 53	923 192 4239	Thermistor Ass'y K TKS293B	1	8FA-0-5259-16900
* 54	923 192 4222	Thermistor Ass'y K TKS292B/292B	1	8FA-0-5259-17400
* 55	923 192 4215	Thermistor Ass'y K TKS292B/292B	1	8FA-0-5259-17500
* 56	923 192 4208	Thermistor Ass'y K TKS292B/292B	1	8FA-0-5259-17600
57	923 194 7405	Washer Special	1	852-2-1318-10401
58	938 012 6706	Funa 6 SUS305-WSA	1	3-9275-06010
59	923 192 4710	Cooler A6063S-T5	1	852-2-4127-24901
60	623 191 7346	Mounting Plate	1	852-2-2385-15601
61	623 193 1915	Mounting Plate	1	852-2-2385-15701
62	623 191 7292	Packing	1	852-2-2380-98210
63	923 192 6110	Elec. Wiring Diagram SELF DIAGNO	1	8FA-2-5257-68500
* 64	623 193 2127	Solenoid Valve Ass'y VPV-603DU	1	852-0-4509-23000
65	623 191 7353	Cover,Elec.Component Box Ass'y	1	852-0-5302-30700
* 66	923 170 4268	Solenoid Control Valve UKV-18D13	3	854-2-4548-15000
67	923 155 2425	Strainer Ass'y	3	852-0-4506-19500
68	923 195 5448	Valve Ass'y 3/8"	3	852-0-4518-27200
69	623 300 1944	Tube Ass'y	1	852-0-4207-11800
* 70	923 195 8098	Pressure Switch ACB-1UB42W	1	1FA-4-S1H0-08500
71	923 163 8075	Screw Special	4	852-2-2396-15401
72	623 313 6387	Screw Special	4	852-2-2396-22201
73	623 313 6356	Packing	1	852-2-2528-17310
74	623 313 6356	Packing	1	852-2-2528-17310
75	623 313 6349	Packing	1	852-2-2528-16510
76	623 313 6400	Packing	2	852-2-2528-16610
77	623 313 6394	Packing	1	852-2-2528-16710
78	623 313 6370	Packing	2	852-2-2380-93710
79	623 313 6363	Packing	2	852-2-2380-92810
80	923 051 6510	Cushion Rubber	4	852-2-2390-19200

NOTE: Metal and plastic parts will be supplied basically with necessary heat insulation pads or packing.
Each key number with an asterisk (*) means the recommended service parts.

For Parts or Service Assistance please contact your local Sanyo HVAC Contractor or Distributor

United States: SCS, HVAC Solutions
Web: www.SanyoHVAC.com
Parts: hvac.parts@sna.sanyo.com
Service: hvac.service@sna.sanyo.com

Canada: Sanyo Canada Inc.
Web: www.SanyoHVAC.com
Parts/Service: hvac@sci.sanyo.com

2/10 Printed in Japan