



Fantech

SUBMITTAL DATA

FSD SERIES

Inline Centrifugal Fans

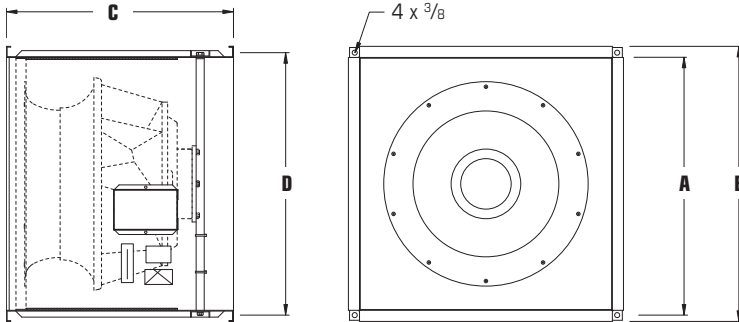

STANDARD FEATURES

- Galvanized steel housing
- Powered by external rotor motorized mixed flow impeller
- Permanently lubricated sealed ball bearings
- 100% speed controllable
- Automatic reset thermal overload protection
- Prewired electrical box
- Three-year factory warranty

Model	A	B	C	D	Metal Gauge	Avg Wt. (lbs)
FSD 18	17 ⁵ / ₈	19 ³ / ₈	15 ³ / ₄	18 ¹ / ₂	16	55
FSD 20	19 ³ / ₄	21 ¹ / ₂	17 ³ / ₄	20 ⁵ / ₈	16	65
FSD 22	21 ¹ / ₂	23 ³ / ₈	19	22 ¹ / ₂	16	95
FSD 26	26	27 ³ / ₄	20	26 ⁷ / ₈	16	135

All dimensions in inches.

Fan Specifications							Motor Specifications				
Line	Qty	Model No.	Tag	CFM	SP	Fan RPM	Watts	Volts	Phase	Hertz	Encl
1											
2											
3											
4											
5											

Accessory Items	1	2	3	4	5	Accessory Items	1	2	3	4	5
<input type="checkbox"/>						<input type="checkbox"/>					
<input type="checkbox"/>						<input type="checkbox"/>					
<input type="checkbox"/>						<input type="checkbox"/>					
<input type="checkbox"/>						<input type="checkbox"/>					
<input type="checkbox"/>						<input type="checkbox"/>					

Project: _____ Submitted: _____

Customer: _____ Approved: _____

Location: _____



Fantech

United States 10048 Industrial Blvd. • Lenexa, KS 66215 • 1.800.747.1762
Canada 50 Kanalfakt Way • Bouctouche, NB E4S 3M5 • 1.800.565.3548

www.fantech.net

Article #: 450375
Rev Date: 052810

Fantech, reserves the right to modify, at any time and without notice, any or all of its products' features, designs, components and specifications to maintain their technological leadership position.